



## DESCRIPTION

The 1N4001WA~1N4007WA are available in SOD-123FL package

## FEATURES

- Available in SOD-123FL package

## ORDERING INFORMATION

Package Type	Part Number
SOD-123FL	1N4001WA
	1N4002WA
	1N4003WA
	1N4004WA
	1N4005WA
	1N4006WA
	1N4007WA
Note	SPQ: 3,000pcs/Reel
AiT provides all RoHS Compliant Products	

## PIN DESCRIPTION





## ABSOLUTE MAXIMUM RATINGS

Ratings at 25°C ambient temperature unless otherwise specified. Single phase half-wave 60 Hz, resistive or inductive load, for capacitive load current derate by 20 %.

Parameter		Symbol	1N4001WA	1N4002WA	1N4003WA	1N4004WA	1N4005WA	1N4006WA	1N4007WA	Unit
Maximum Repetitive Peak Reverse Voltage		$V_{RRM}$	50	100	200	400	600	800	1000	V
Maximum RMS Voltage		$V_{RMS}$	35	70	140	280	420	560	700	V
Maximum DC Blocking Voltage		$V_{DC}$	50	100	200	400	600	800	1000	V
Maximum Average Forward Rectified Current at $T_A=65^\circ\text{C}$		$I_{F(AV)}$	1							A
Peak Forward Surge Current 8.3ms Single Half Sine Wave Superimposed on Rated Load (JEDEC Method)		$I_{FSM}$	25							A
Maximum Instantaneous Forward Voltage at 1A		$V_F$	1.1							V
Maximum DC Reverse Current at Rated DC Blocking Voltage	$T_A=25^\circ\text{C}$	$I_R$	5							uA
	$T_A=125^\circ\text{C}$		100							
Typical Junction Capacitance		$C_j$	4							pF
Typical Thermal Resistance		$R_{\theta JA}$	180							°C/W
Operating and Storage Temperature Range		$T_J,$ $T_{STG}$	-55 ~+150							°C

NOTE1: Measured at 1MHz and applied reverse voltage of 4 V D.C.

NOTE2: Thermal resistance from junction to ambient at 0.375" (9.5 mm) lead length, P.C.B. mounted



## TYPICAL CHARACTERISTICS

Figure. 1 Forward Current Derating Curve

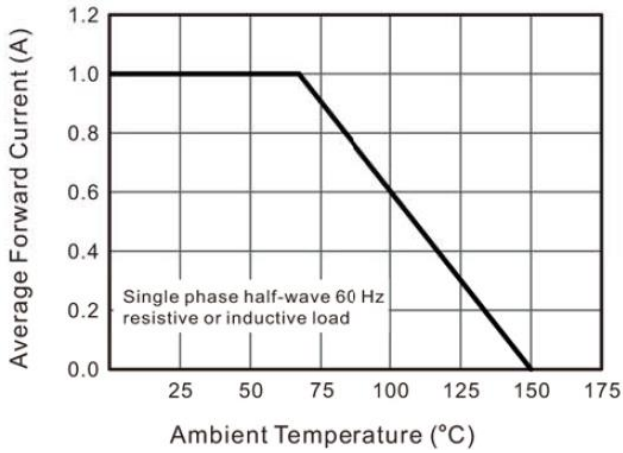

Figure. 2 Typical Instantaneous Reverse Characteristics

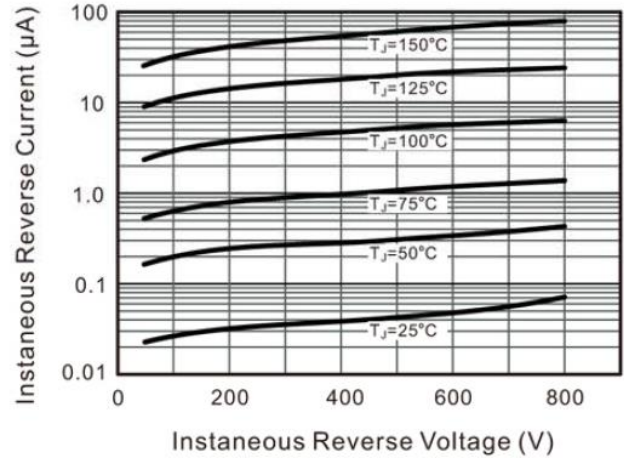

Figure. 3 Typical Forward Characteristic

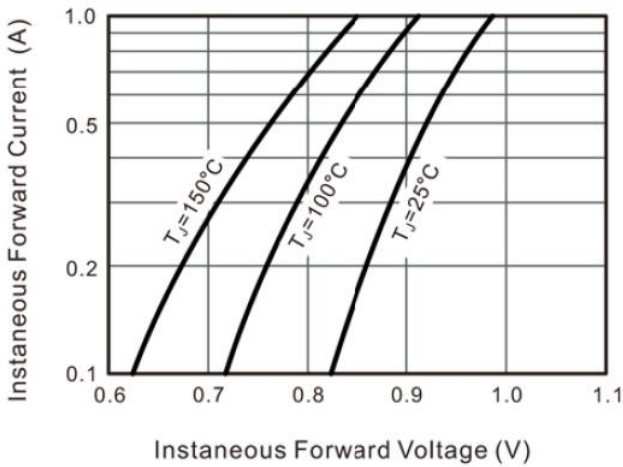
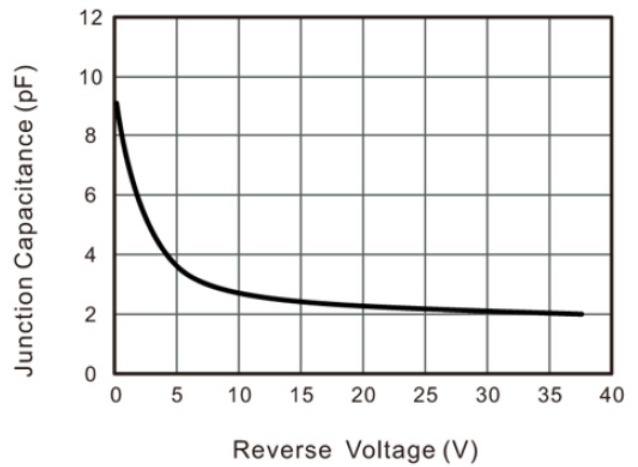
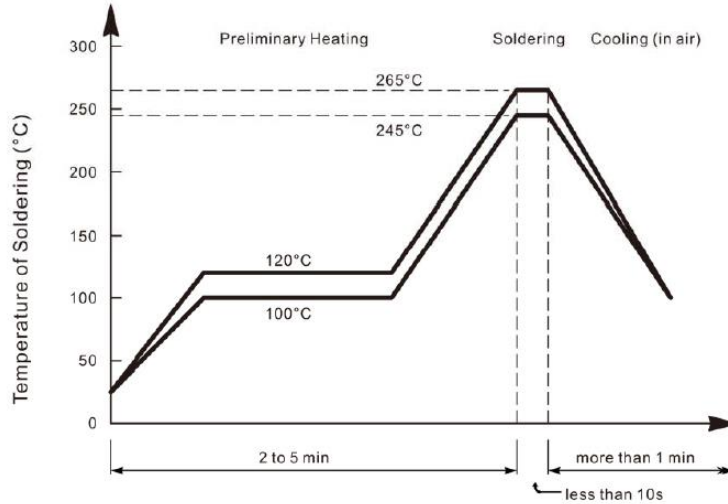

Figure. 4 Typical Junction Capacitance





### Recommended Condition of Flow Soldering



### Recommended Condition of Reflow Soldering

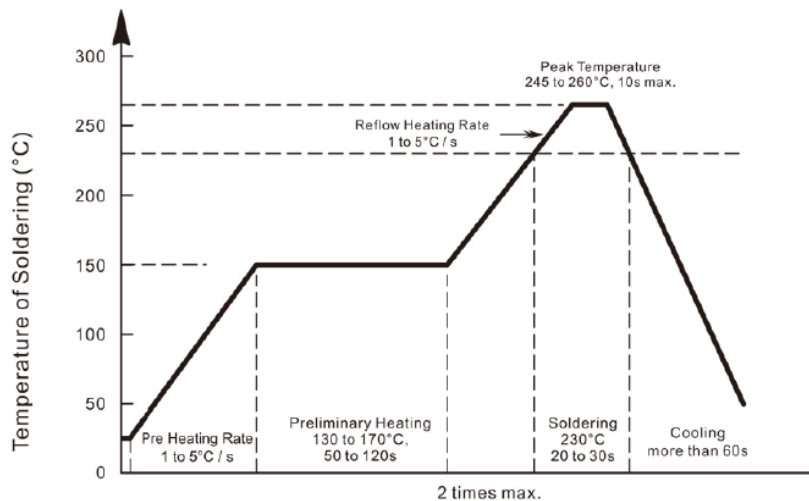

Recommended peak temperature is over 245°C. If peak temperature is below 245°C, you may adjust the following parameters; time length of peak temperature(longer), time length of soldering (longer), thickness of solder paste (thicker)

### Condition of hand soldering

Temperature: 370°C

Time: 3s max.

Times: one time

### Remark:

Lead free solder paste (96.5Sn/3.0Ag/5Cu)



**PACKAGE INFORMATION**

Dimension in SOD-123FL (Unit: mm)

Plastic surface mounted package; 2 leads

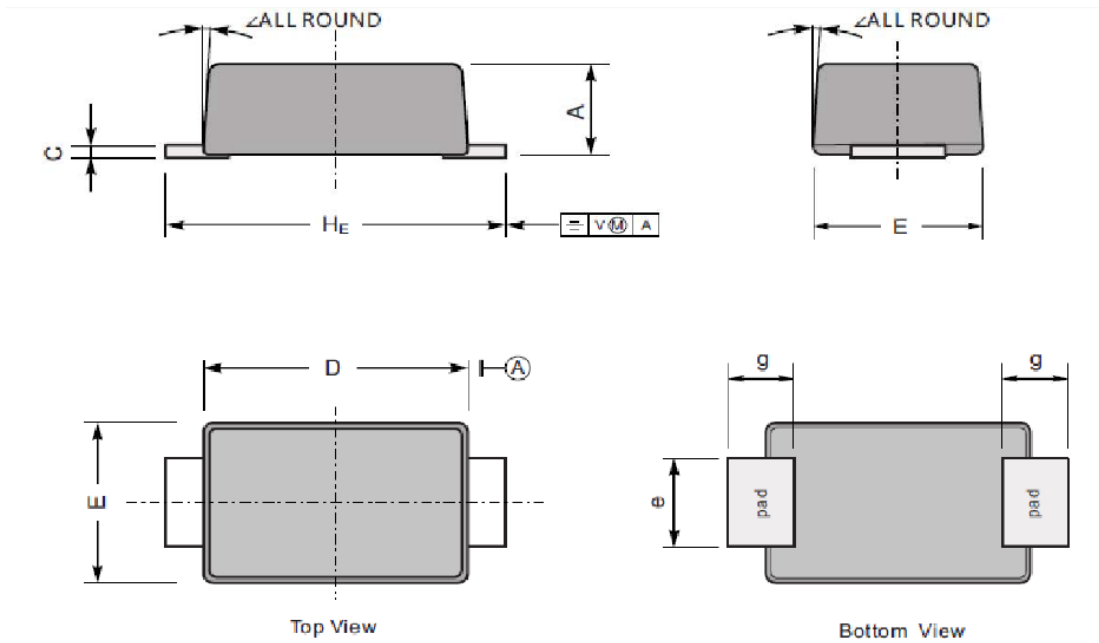

The recommended mounting pad size

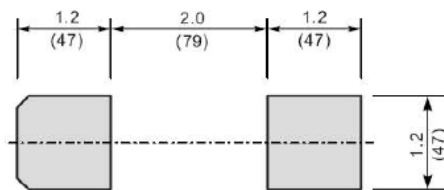

Unit:  $\frac{\text{mm}}{\text{mil}}$

UNIT		A	c	D	E	e	g	H <sub>E</sub>	$\angle$
mm	Max	1.1	0.20	2.9	1.9	1.1	0.9	3.8	7°
	Min	0.9	0.12	2.6	1.7	0.8	0.7	3.5	
mil	Max	43	7.9	114	75	43	35	150	
	Min	35	4.7	102	67	31	28	138	



## IMPORTANT NOTICE

AiT Semiconductor Inc. (AiT) reserves the right to make changes to any its product, specifications, to discontinue any integrated circuit product or service without notice, and advises its customers to obtain the latest version of relevant information to verify, before placing orders, that the information being relied on is current.

AiT Semiconductor Inc.'s integrated circuit products are not designed, intended, authorized, or warranted to be suitable for use in life support applications, devices or systems or other critical applications. Use of AiT products in such applications is understood to be fully at the risk of the customer. As used herein may involve potential risks of death, personal injury, or severe property, or environmental damage. In order to minimize risks associated with the customer's applications, the customer should provide adequate design and operating safeguards.

AiT Semiconductor Inc. assumes to no liability to customer product design or application support. AiT warrants the performance of its products of the specifications applicable at the time of sale.